



Shortgrove Manor Farm Dovehouse Lane

Kenilworth, LU6 2PQ

£4,000,000



Shortgrove Manor Farm

Kensworth, LU6 2PQ

An outstanding Grade II listed equestrian home in a private rural setting of circa 20 acres, approached via an impressive, gated tree lined driveway culminating in a large central courtyard. Characterful, cosy seven-bedroom farmhouse of 3,915 sq ft combining elegant reception rooms with exposed timbers and deep inglenook fireplaces. Fabulous principal suite with dressing room and en-suite and further bedrooms across the first and second floor, with views over the beautiful gardens and orchard.

Superb equestrian facilities comprising 17 loose boxes, including an 8 stable American Barn with a washroom, feed and hay store, tack room, and a horse walker. The fields are all post and rail with automatic troughs.

Self-contained, two-bedroom cottage and studio flat approached over an external staircase. Indoor swimming pool, kitchen, dining area and open fireplace. Home office finished with polished panelling and fitted bookshelves. Beautiful, double-height Guest Suite.

Shortgrove Manor Farm nestles in the eastern reaches of the Chiltern Hills surrounded by well-maintained agricultural land and mature woodland. The village of Kensworth is just 0.5 miles away and benefits from a primary school, two shops and a pub. Harpenden town centre and station with links to central London is 8.5 miles away.

Council Tax Bands
Farm House Band H
Cottage Band D
Studio Flat Band F



Floor Plan

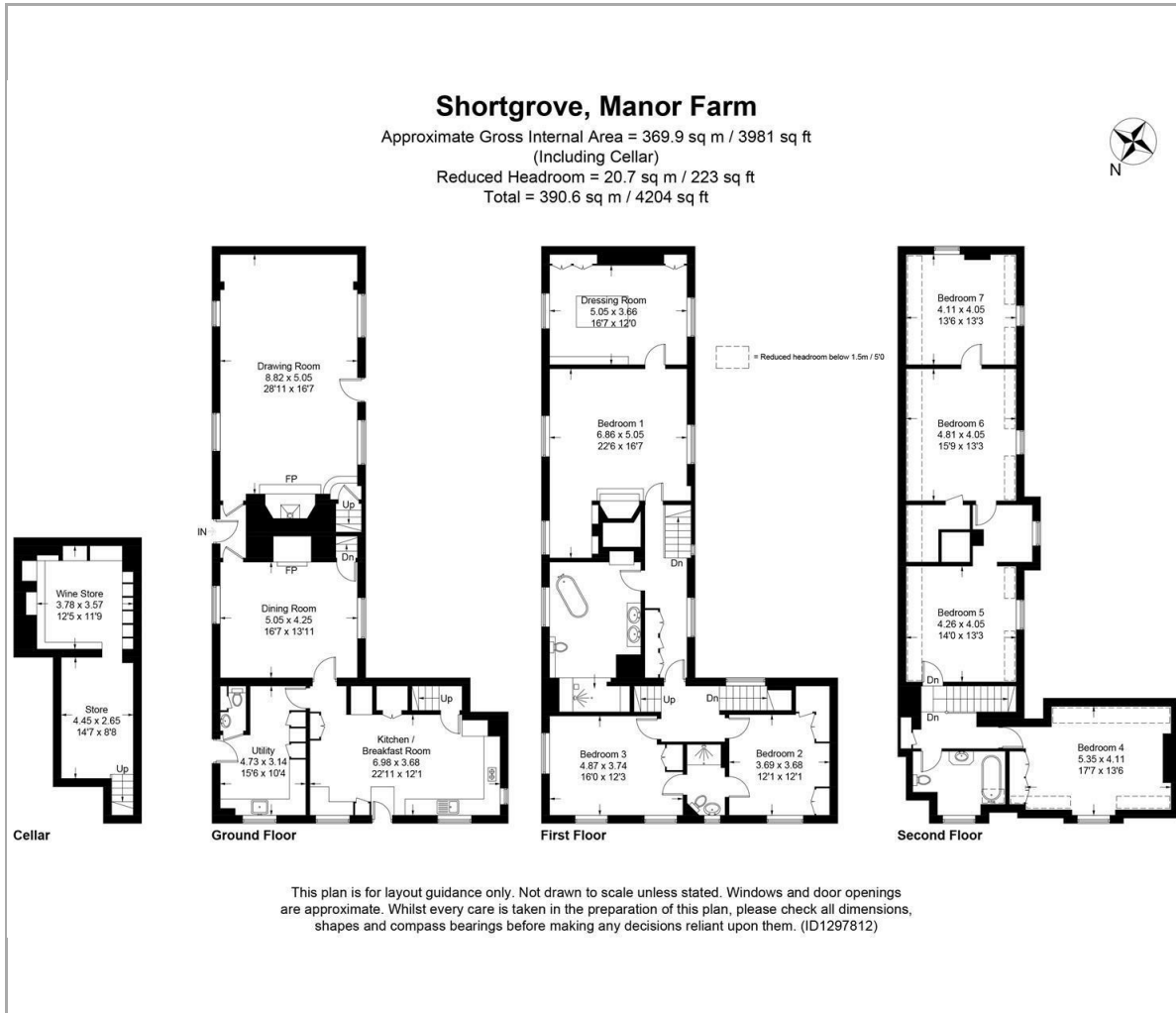

Viewing

Please contact our Whittaker & Co. Office on 01582 761500 if you wish to arrange a viewing appointment for this property or require further information.

These particulars, whilst believed to be accurate are set out as a general outline only for guidance and do not constitute any part of an offer or contract. Intending purchasers should not rely on them as statements of representation of fact, but must satisfy themselves by inspection or otherwise as to their accuracy. No person in this firm's employment has the authority to make or give any representation or warranty in respect of the property.

Area Map

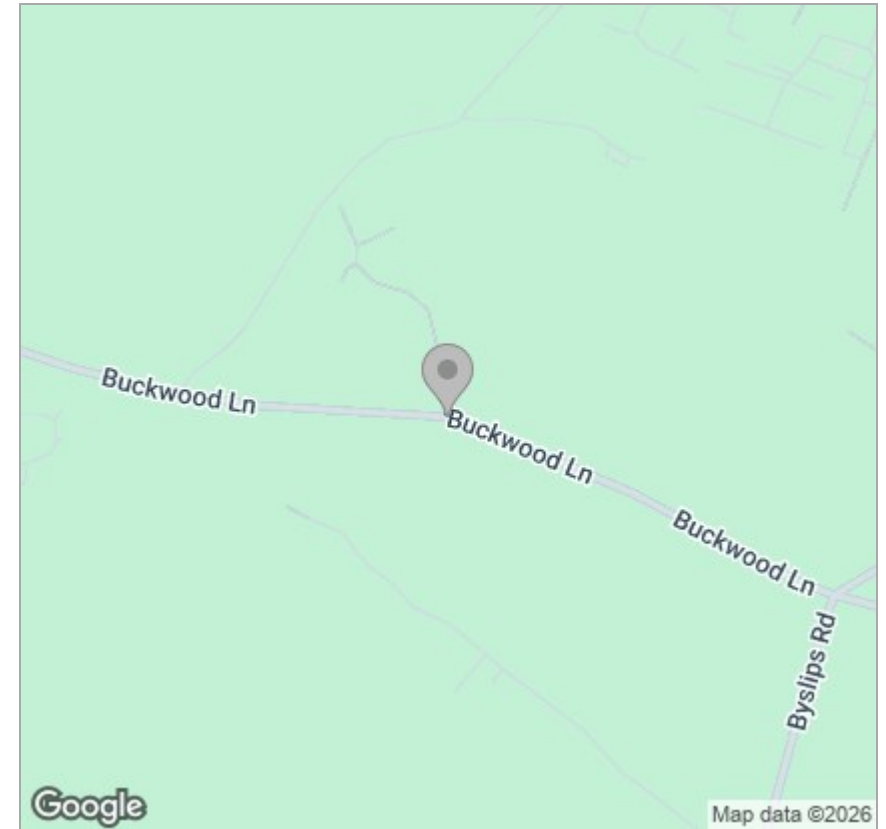

Energy Efficiency Graph

